

Building 25 Wayfinding Map

BASEMENT, GROUND & FIRST FLOOR



**ZUCKERBERG
SAN FRANCISCO GENERAL**
Hospital and Trauma Center

FLOOR	SERVICE
7	ACE Acute Care for Elders
4	Acute Dialysis Suite
1	Admitting
4	Adolescent Rooms
B	Anatomic Pathology & Morgue
G	Blood Bank
G	Cardiac Cath Lab
B	Cardiac Diagnostic Services
3	Cardiac ICU
6	Cardiology
1	Cashiers
1	Eligibility
1	Emergency Department
G	Endoscopy Services
6	Faculty Inpatient Service
4	General ICU
6	General Medical Surgical
5	General Medical Surgical
4	General Surgical
B	Imaging Services
B	Inpatient Pharmacy
G	Interventional Radiology Suite (Neuro & Body Scans)
1	Main Lobby
3	Medical ICU
2	Family Birth Center
3	Neuroscience ICU
4	Neuroscience Medical Surgical
2	NICU
5	Oncology
5	Palliative Care
2	Pediatric Care
G	Perioperative Services (PACU, Surgery Center, Operating Room)
B	Pulmonary Function Lab
7	Rooftop Garden
3	Surgical & Trauma ICU
2	Well Baby Nursery

BASEMENT

BAY BRIDGE

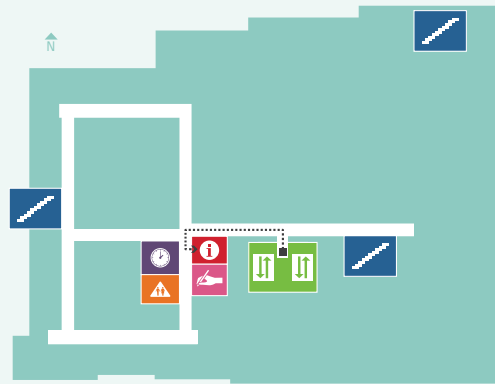

Cardiac Diagnostic Services
Imaging Services
Pulmonary Function Lab

GROUND

PRESIDIO

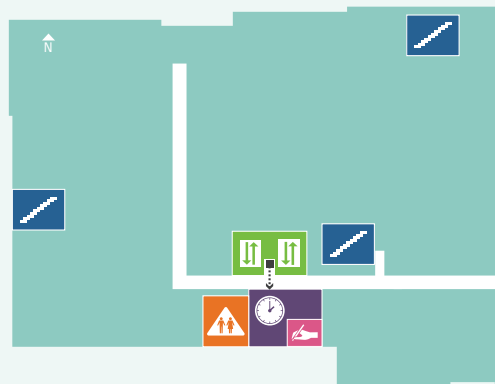

Endoscopy Services
Cardiac Cath Lab
Interventional Radiology Suite
Blood Bank
Perioperative Services (PACU, Surgery Center, Operating Room)

to bldg 5

FIRST FLOOR

EMBARCADERO

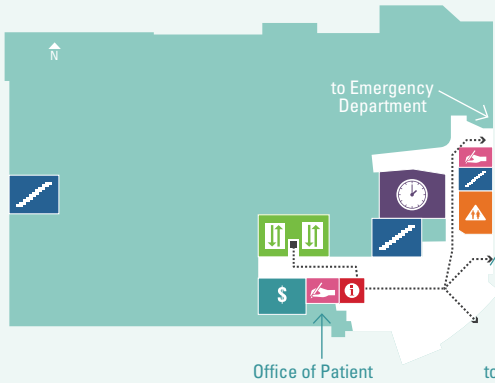

Main Lobby
Admitting
Cashiers
Eligibility
Emergency Department
Office of Patient Experience

Office of Patient Experience

to bldg 5

LEGEND

	Visitor Pathway		Stairs		Elevator		Restrooms		Info		Waiting Room		Admitting/Registration		Cashier		Check Point		Intercom
--	-----------------	--	--------	--	----------	--	-----------	--	------	--	--------------	--	------------------------	--	---------	--	-------------	--	----------

Building 25 Wayfinding Map

SECOND, THIRD, FOURTH, FIFTH, SIXTH & SEVENTH FLOORS



**ZUCKERBERG
SAN FRANCISCO GENERAL**
Hospital and Trauma Center

2ND FLOOR

OCEAN BEACH

Pediatric Care & Family Birth Center | NICU



3RD FLOOR

CIVIC CENTER

Critical Care ICU



4TH FLOOR

LOMBARD

General ICU | Acute Dialysis Suite

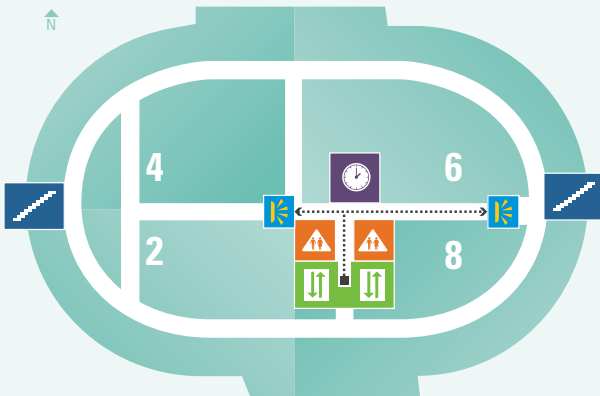

5TH FLOOR

MISSION DOLORES

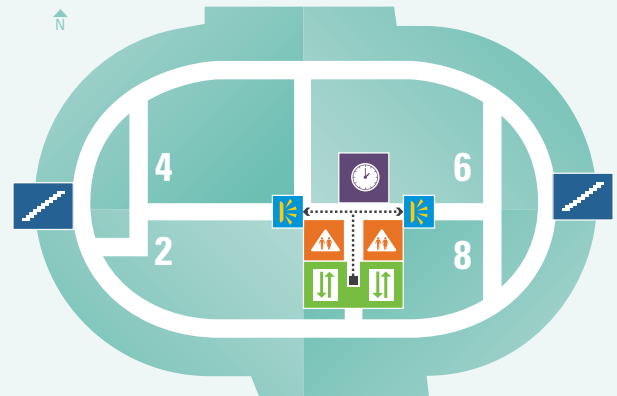

6TH FLOOR

TWIN PEAKS



7TH FLOOR

GOLDEN GATE

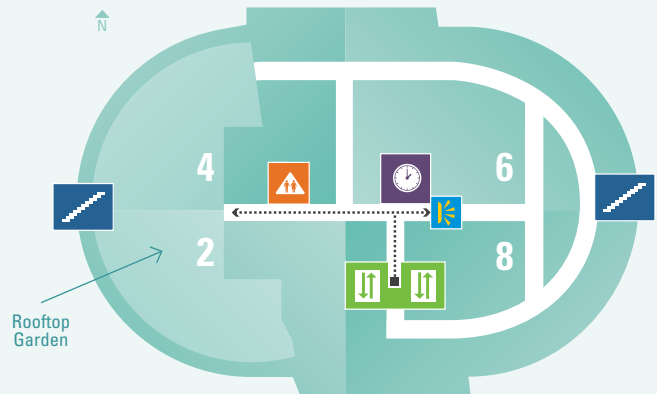

LEGEND

- Visitor Pathway
- Stairs
- Elevator
- Restrooms
- Info
- Waiting Room
- Admitting/Registration
- Cashier
- Check Point
- Intercom